

## ELECTRIC SADDLE INSTALLATION INSTRUCTIONS

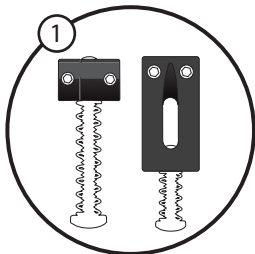

STEP 1. Once you have removed the old saddles and replaced them with your new Graph Tech saddles, set the intonation "starting point": screw the intonation screw in so that you can just see it coming out the other side of the saddle. Tune your guitar to concert pitch.

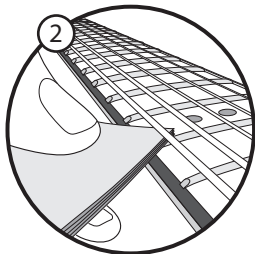

STEP 2. To determine correct string height, measure the gap between the top of the twelfth fret and the bottom of the low E string. It should be around 3mm/.118", or about a stack of 12 business cards if you don't have a ruler. Adjust each string, following the radius of the fretboard. For the high E string, the gap should be around 2mm/.079", or about a stack of 8 business cards.

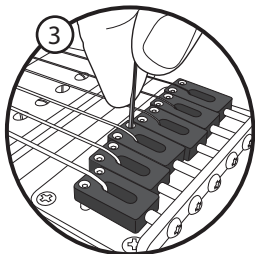

STEP 3. To adjust your string height, use the allen key supplied with your saddles to lower or raise your saddles until correct string height is achieved. Be sure to adjust both height adjustment screws equally to keep the saddle level. Tune guitar to concert pitch after each adjustment. Repeat for each string.

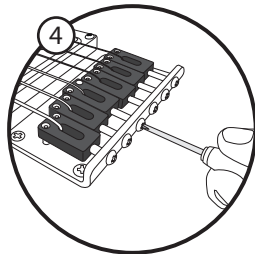

STEP 4. The fretted 12th position of a string should match its 12th fret harmonic (lightly touch the string right above the 12th fret and pluck). Adjust the intonation screw with a screwdriver. Shortening the distance between the saddle and nut will increase the pitch of the harmonic; increasing the distance lower the pitch. Retune to concert pitch after each adjustment. Repeat for each string.

**NEED HELP?** Contact **GRAPH TECH GUITAR LABS** at 604-940-5353, via e-mail at [sales@graphtech.com](mailto:sales@graphtech.com), or consult our website at [www.graphtech.com](http://www.graphtech.com)